

motovibratori

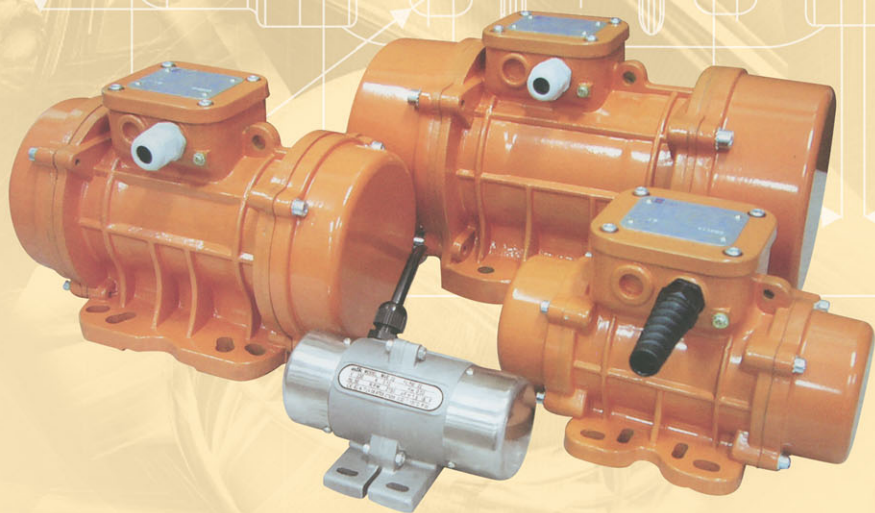

adk

*ELECTRIC VIBRATOR MOTORS*

Today **adk** all range of vibrators motor are one of the most efficient products available on the world market to meet all vibrating equipment environments in performance and quality needs of all customer. The ranges provides all components final product quality with accurate design come with technology innovation to assure all of our range vibrators motor able to satisfy for the demanding market needs.

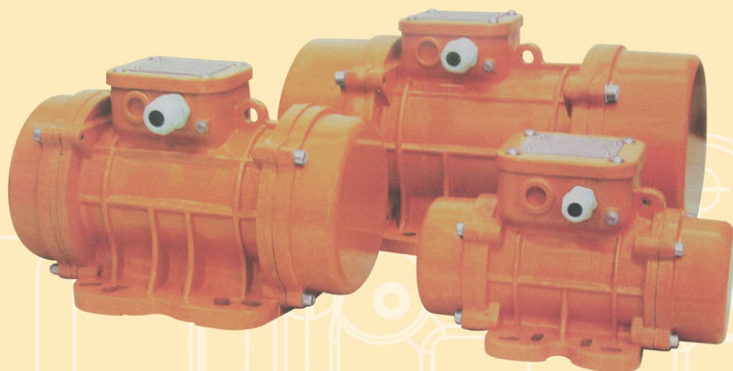

#### THE QUALITY OF PRODUCTS ....

The main features of adk vibrators motor are with HIGH STANDARD material and features as with :

- Electrical motor are manufacture with low loss lamination core and which increase the efficiency and will reduces the body heating temperature .
- Solid cast iron and high resistance aluminium hosing to reduce the mechanical stress.
- High load special execution bearing.
- Labyrinth system for bearing seal with wide restraining chamber
- Squirrel cage rotor designed to have high efficient starting load torque
- Insulation Class : F
- Mechanical Protection : IP 65

#### TYPE OF INDUSTRIES APPLICATION....

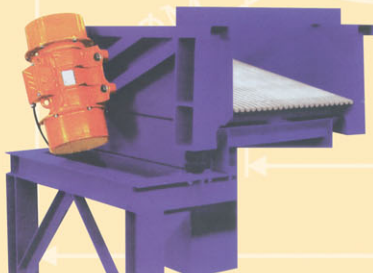

- \* Ceramics Industries
- \* Sand mill Industries
- \* Food Industries
- \* Qurray mill Industries
- \* Rubber & Plastic Industries
- \* Minning mill Industries
- \* Wood Industries
- \* Cement Manufacture Plants
- \* Concrete Batching Industries
- \* Screening Equipment
- \* Waste Water Treatment Plants
- \* Steel / Foundries Industries

TYPE	Rpm min - 1		MECHANICAL FEATURES				ELECTRICAL FEATURES				Weight kg	Rif.
			Static Mov. kg / cm		Cent. Force kg		Input Power Watt		Current (A)			
	50 hz	60 hz	50 hz	60 hz	50hz	60 hz	50 hz	60hz	400 v 50 hz	460 v 60 hz		
VM 65-2	3000	3600	1.35	0.8	70	60	80	90	0.16	0.18	4.2	A
VM 100-2			2.00	1.50	100	110	100	110	0.19	0.18	4.7	A
VM 200-2			3.70	2.60	180	189	180	200	0.35	0.35	6.8	B
VM 300-2			6.20	4.45	320	320	270	260	0.50	0.45	10.2	C
VM 400-2			8.00	5.60	400	410	300	360	0.55	0.60	11.5	C
VM 500-2			10.30	7.40	530	535	500	580	0.95	0.95	16	D
VM 700-2			14.90	10.50	750	760	660	750	1.20	1.24	16.8	D
VM 800-2			15.70	11.00	790	800	750	900	1.45	1.50	26.6	D
VM 1200-2			20.20	14.00	1000	1010	950	1150	1.80	1.90	28.5	D
VM 1400-2			27.60	18.80	1350	1360	1300	1390	2.45	2.25	33	D
VM 1600-2			31.30	22.20	1600	1610	1600	1620	2.94	2.60	52	D
VM 2000-2			36.70	27.60	2020	1997	2000	2200	3.75	3.40	58	D
VM 2300-2			46.00	31.90	2300	2300	2400	2500	4.40	3.94	67	D
VM 3200-2			68.00	44.00	3250	3170	3000	3000	5.30	4.65	96.6	D
VM 5000-2	103.00	70.00	5000	5050	4000	4000	7.20	6.30	103	D		
VM 6500-2	129.00	90.00	6500	6550	5500	5300	9.50	8.00	222	D		
VM 9500-2	179.50	129.00	9020	9370	10000	9300	17.00	14.00	232	D		

**WORKING MOMENT = 2 X STATIC MOMENT**

TYPE	D		I		A mm	B mm	C mm	E mm	F mm	G mm	H mm	L mm	ØK mm	ØM mm	Holes no
	50 hz	60 hz	50 hz	60 hz											
VM 65-2	211	211	45	45	106	62-74 33	130	136	48	12	94	121	86	9	4
VM 100-2	211	211	45	45	83-102	62-74 33	33	136	48	12	94	121	86	9	4
VM 200-2	217	217	40	40	106	62-74	130	158	64	14	120	123	112	9	4
VM 300-2	259	259	43	43	110 125	80 90	155	177	80	14	144	165	132	11 13	4
VM 400-2	259	259	43	43	110 115	124 135	155	177	80	14	144	165	132	11	4
VM 500-2	338	338	75	75	140	105	168	202	92	22	168	178	158	13	4
VM 700-2	338	338	75	75	140	105	168	202	92	22	168	178	158	13	4
VM 800-2	311	311	47	47	170	120	209	211	94	22	180	205	170	17	4
VM 1200-2	397	397	90	90	170	120	209	211	94	22	180	205	170	17	4
VM 1400-2	397	397	90	90	170	120	209	211	94	22	180	205	170	17	4
VM 1600-2	448	448	98	98	190	140	228	243	120	30	246	220	221	17	4
VM 2000-2	448	448	98	98	190	140	228	243	120	30	246	220	221	17	4
VM 2300-2	448	448	98	98	190	140	228	243	120	30	246	220	221	17	4
VM 3200-2	538	538	115	115	255	155	298.5	311	140	35	295	273	265	23.5	4
VM 5000-2	588	588	140	140	255	155	298.5	311	140	35	295	273	265	23.5	4
VM 6500-2	605	605	120	120	320	200	378	383	200	50	424	325	378	28	4
VM 9500-2	605	605	120	120	320	200	378	383	200	50	424	325	378	28	4

TYPE	Rpm min - 1		MECHANICAL FEATURES				ELECTRICAL FEATURES				Weight kg	Rif.
			Static Mov. kg / cm		Cent. Force kg		Input Power Watt		Current ( A )			
	50 hz	60 hz	50 hz	60 hz	50hz	60 hz	50 hz	60hz	400 v 50 hz	460 v 60 hz		
VM 50-4	1500	1800	2.15	1.90	27	36	40	50	0.31	0.28	5	A
VM 90-4			5.95	4.20	75	76	90	100	0.26	0.22	8	B
VM 200-4			15.40	10.80	195	196	180	190	0.45	0.39	12	C
VM 400-4			33.40	23.40	420	423	300	340	0.66	0.57	20	D
VM 500-4			40.15	28.00	504	500	350	400	0.70	0.60	21	D
VM 700-4			56.85	39.40	715	710	620	710	1.18	1.02	28	D
VM 1100-4			88.70	62.00	1114	1120	650	780	1.25	1.08	36	D
VM 1400-4			108.60	76.70	1365	1388	900	1100	1.75	1.52	60	D
VM 1700-4			137.30	92.00	1720	1665	1200	1300	2.25	1.95	62	D
VM 2400-4			187.70	137.40	2358	2480	1600	1900	3.20	2.78	68	D
VM 3000-4			248.60	169.80	3125	3071	1900	2300	3.80	3.30	98	D
VM 3800-4			307.00	204.70	3853	3700	2200	2600	4.20	4.15	130	D
VM 4300-4			340.00	240.80	4310	4250	2500	3000	5.70	5.70	135	D
VM 5500-4			432.00	303.80	5500	5500	3600	3450	6.50	6.60	193	D
VM 7200-4	570.00	397.30	7250	7180	5000	6000	9.60	9.40	255	D		
VM 9000-4	700.00	495.00	9000	9000	7000	8000	12.00	12.00	270	D		
VM 10000-4	800.10	588.30	10000	9870	7800	9400	13.00	13.00	313	E		

**WORKING MOMENT = 2 X STATIC MOMENT**

TYPE	D		I		A mm	B mm	C mm	E mm	F mm	G mm	H mm	L mm	ØK mm	ØM mm	Holes no
	mm	mm	mm	mm											
	50 hz	60 hz	50 hz	60 hz											
VM 50-4	211	211	45	45	106 83-102	62-74 33	130	136	48	12	94	121	86	9 7	4
VM 90-4	217	217	40	40	106	62-74	130	158	64	14	120	123	112	9	4
VM 200-4	259	259	43	43	110 110 115	80 90 124 135	155	177	80	14	144	165	132	11 13 11 11	4
VM 400-4	338	338	75	75	140	105	168	202	92	22	168	178	158	13	4
VM 500-4	338	338	75	75	140	105	168	202	92	22	168	178	158	13	4
VM 700-4	397	397	90	90	170	120	209	211	94	22	180	205	170	17	4
VM 1100-4	451	451	112	112	170	120	209	211	94	22	180	205	170	17	4
VM 1400-4	448	448	98	98	190	140	228	243	120	30	246	220	221	17	4
VM 1700-4	510	510	98	98	190	140	228	243	120	30	246	220	221	17	4
VM 2400-4	510	510	129	129	190	140	228	243	120	30	246	220	221	17	4
VM 3000-4	522	522	123	123	225	155	270	273	138	38	276	250	244	22	4
VM 3800-4	588	588	140	140	255	155	298.5	311	140	35	295	273	265	24	4
VM 4300-4	588	588	140	140	255	155	298.5	311	140	35	295	273	265	24	4
VM 5500-4	603	603	130	130	280	180	330	346	160	35	345	304	311	26	4
VM 7200-4	605	605	120	120	320	200	378	383	200	50	350	325	311	28	4
VM 9000-4	605	605	120	120	320	200	378	383	200	50	350	325	378	28	4
VM 10000-4	686	686	140	140	380	125	448	420	202	45	424	367	379	38	6

TYPE	Rpm min - 1		MECHANICAL FEATURES				ELECTRICAL FEATURES				Weight kg	Rif.
			Static Mov. kg / cm		Cent. Force kg		Input Power Watt		Current (A)			
	50 hz	60 hz	50 hz	60 hz	50hz	60 hz	50 hz	60hz	400 v 50 hz	460 v 60 hz		
VM 50-6	1000	1200	9.50	6.50	53	53	100	140	0.40	0.40	12.80	C
VM 100-6			18.80	13.10	105	106	120	140	0.40	0.40	13.50	C
VM 200-6			33.50	23.40	187	188	200	210	0.53	0.51	20.5	D
VM 300-6			47.30	33.50	267	269	300	380	0.67	0.64	30	D
VM 500-6			85.00	59.80	475	479	350	400	1.20	1.15	36	D
VM 800-6			138.00	108.60	767	873	680	760	1.29	1.26	59	D
VM 1100-6			187.70	137.30	1048	1104	750	800	1.42	1.32	68	D
VM 1500-6			284.50	196.50	1590	1580	1100	1300	2.10	2.00	77	D
VM 2100-6			373.00	248.70	2083	2000	1500	1800	3.00	3.00	111	D
VM 2600-6			467.50	306.70	2610	2466	1900	2100	3.60	3.30	140	D
VM 3000-6			540.30	379.70	3017	3053	2200	2400	4.50	4.30	148.7	D
VM 3800-6			680.40	437.40	3799	3517	2500	3000	4.67	4.85	216	D
VM 4700-6			838.40	584.00	4681	4697	3200	3900	6.50	6.00	230	D
VM 5200-6			929.90	655.00	5192	5263	3800	4000	6.92	6.36	280	D
VM 6500-6			1165.20	824.00	6500	6625	4300	5000	7.76	7.80	303	D
VM 8000-6			1436.00	929.80	8018	7476	7100	7500	12.60	11.60	326	D
VM 9000-6	1600.00	1165.00	8936	9369	7500	8300	13.20	12.60	340	D		
VM 10000-6	1788.40	1239.98	9986	9970	7600	8400	13.50	12.70	379	E		
VM 13000-6	2329.80	1647.40	13000	13246	10000	10000	17.00	16.00	422	E		

**WORKING MOMENT = 2 X STATIC MOMENT**

TYPE	D		I		A mm	B mm	C mm	E mm	F mm	G mm	H mm	L mm	ØK mm	ØM mm	Holes no
	50 hz	60 hz	50 hz	60 hz											
	VM 50-6	259	259	43											
VM 100-6	299	299	63	63	110 115	124 135	155	177	80	14	144	165	132	11	4
VM 200-6	338	338	75	75	140	105	168	202	92	22	168	178	158	13	4
VM 300-6	397	397	90	90	170	120	209	211	94	22	18	205	170	17	4
VM 500-6	451	451	112	112	170	120	209	211	94	22	180	205	170	17	4
VM 800-6	448	448	98	98	190	140	228	243	120	30	246	220	221	17	4
VM 1100-6	510	510	129	129	190	140	228	243	120	30	246	220	221	17	4
VM 1500-6	562	562	154	154	190	140	228	243	120	30	246	220	221	17	4
VM 2100-6	616	616	170	170	225	155	270	273	138	38	276	250	244	22	4
VM 2600-6	708	708	200	200	255	155	298.5	311	140	35	295	273	265	23.5	4
VM 3000-6	708	708	200	200	255	155	298.5	311	140	35	295	273	265	23.5	4
VM 3800-6	683	683	170	170	280	180	330	346	160	35	345	304	311	26	4
VM 4700-6	733	733	195	195	280	180	330	346	160	35	345	304	311	26	4
VM 5200-6	645	645	140	140	320	200	378	383	200	50	424	325	378	28	4
VM 6000-6	685	685	160	160	320	200	378	383	200	50	424	325	378	28	4
VM 8000-6	785	785	210	210	320	200	378	383	200	50	424	325	378	28	4
VM 9000-6	785	785	210	210	320	200	378	383	200	50	424	325	378	28	4
VM 10000-6	826	826	210	210	380	125	448	383	202	45	424	367	379	38	6
VM 13000-6	926	926	260	260	380	125	448	420	202	45	424	367	379	38	6

TYPE	Rpm min - 1		MECHANICAL FEATURES				ELECTRICAL FEATURES				Weight kg	Rif.
			Static Mov. kg / cm		Cent. Force kg		Input Power Watt		Current (A)			
	50 hz	60 hz	50 hz	60 hz	50hz	60 hz	50 hz	60hz	400 v 50 hz	460 v 60 hz		
VM 150-8	750	900	33.40	33.40	105	151	230	250	1.14	1.14	18	D
VM 250-8			57.30	57.30	108	259	350	380	1.15	1.15	26	D
VM 400-8			84.00	84.00	264	380	350	380	1.15	1.15	32	D
VM 650-8			137.00	137.00	431	621	500	600	1.20	1.20	54	D
VM 900-8			187.70	187.70	589	849	650	780	1.23	1.23	61	D
VM 1300-8			299.00	299.00	941	1355	1000	1100	1.83	1.83	101	D
VM 2100-8			468.00	468.00	1468	2114	1500	1800	2.81	2.81	140	D
VM 3100-8			838.50	838.50	2137	3077	2000	2300	3.77	3.77	213	D
VM 3800-8			980.00	980.00	2633	3792	2500	3000	6.00	6.00	268	D
VM 4200-8			929.00	929.00	2920	4205	2900	3400	6.50	6.50	281	D
VM 5300-8			1165.00	1165.00	3660	5270	4000	4300	8.00	8.00	303	D
VM 6000-8			1435.90	1435.90	4510	6494	5000	5900	10.00	10.00	326	D
VM 10000-8			2200.50	2200.50	6911	9952	6800	7500	13.50	13.50	439	E

**WORKING MOMENT = 2 X STATIC MOMENT**

TYPE	D		I		A mm	B mm	C mm	E mm	F mm	G mm	H mm	L mm	ØK mm	ØM mm	Holes no
	mm	mm	mm	mm											
	50 hz	60 hz	50 hz	60 hz											
VM 150-8	338	338	75	75	140	140	168	202	92	22	168	178	158	13	4
VM 250-8	451	451	112	112	170	170	209	211	94	22	180	205	170	17	4
VM 400-8	451	451	112	112	170	170	209	211	94	22	180	205	170	17	4
VM 650-8	510	510	129	129	190	190	228	243	115	30	246	220	221	17	4
VM 900-8	510	510	129	129	190	190	228	243	115	30	246	220	221	17	4
VM 1300-8	556	556	140	140	225	225	270	311	138	38	276	250	238	22	4
VM 2100-8	708	708	200	200	225	225	298.5	273	140	35	295	273	265	23.5	4
VM 3000-8	683	683	170	170	280	280	330	346	160	35	345	304	311	26	4
VM 3800-8	733	733	195	195	280	280	330	346	160	35	345	304	311	26	4
VM 4200-8	645	645	140	140	320	320	378	388	200	50	424	325	378	28	4
VM 5300-8	685	685	160	160	320	320	378	388	200	50	424	325	378	28	4
VM 6000-8	785	785	210	210	320	320	378	388	200	50	424	325	378	28	4
VM 10000-8	926	926	260	260	380	380	448	420	202	45	424	367	379	38	6



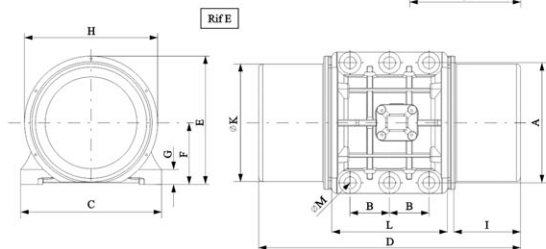
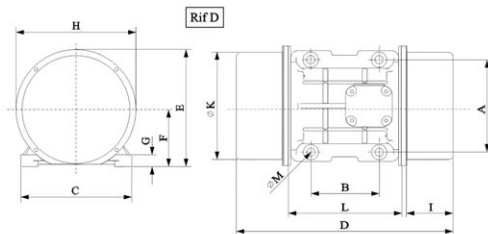
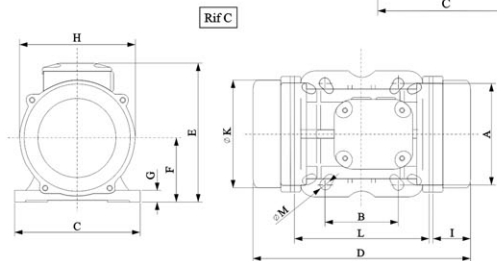
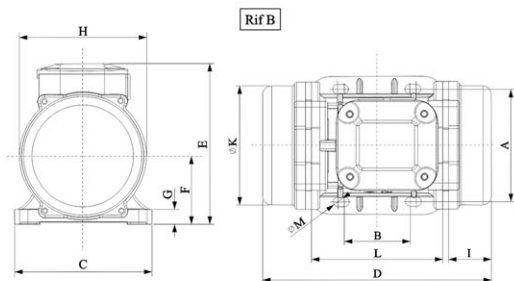
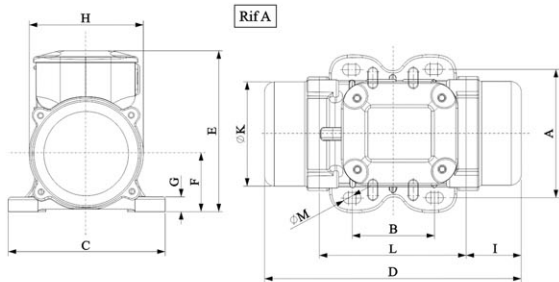





## Some Type of Industries Application



# PT INTERJAYA SURYA MEGAH

SOLUTIONS FOR YOUR POWER & TRANSMISSION NEEDS

#### Head Office :

Jl. Rungkut Industri III / 55  
Surabaya 60293 - Indonesia

Telp. (031) 849 7070 (Hunting), Fax. (031) 842 0212, 842 0390

E-mail: support@interjaya.com

Website: www.interjaya.com

#### Branch Office :

Komplek Pergudangan Arcadia Blok G12 No. 10  
Jl. Daan Mogot Km 21.5, Tangerang

Telp. (021) 2900 6565 (Hunting), Fax. (021) 2900 6547, 2900 6548

E-mail: ism@interjaya.com

#### Rep. Office :

- Jl. Tol Jakarta Cikampek Km 37, Ruko Spanish Square Blok B No. 6  
Kota Deltamas - Cikarang - Bekasi

Telp. (021) 899 700 10 (Hunting), 713 703 74, Fax. (021) 899 705 55

E-mail: ism.ckr@interjaya.com

- Ruko Cabaret Blok KF 02 No. 12, Komplek Mardigras Perum. Citra Raya  
Cikupa - Tangerang

Telp. (021) 2900 3600 (Hunting), Fax. (021) 2900 3516

E-mail: ism.cikupa@interjaya.com

- Kawasan Industri Candi, Jl. Gatot Subroto Blok XVI no. 6, Semarang

Telp. (024) 7692 8989 (Hunting), Fax. (024) 7692 8988

E-mail: ismsemarang@interjaya.com